

03.

PROFILE ATTACHMENTS

PRECI-HORIX®
ENGLISH



CEKA
ATTACHMENTS
PRECI-LINE

PRECI-HORIX

SIMPLE AND ECONOMICAL

The PRECI-HORIX bar and rider system, developed by Helmut Hader, is the most popular of all bar systems due to its economy and simplicity.

The excellent retention of the plastic clips, the patient comfort, the ease of processing and durability make PRECI-HORIX a first choice by experts for over 40 years.



- ✓ Easily replaceable female riders in three retention levels to choose from
- ✓ The bar pattern may be cast in alloy of choice
- ✓ Extremely suitable for use on implants
- ✓ Direct support and rotational movement
- ✓ The soft snap of the female riders offers the patient security



PRECI-HORIX HOUSING SIMPLIFIES CLIP PLACEMENT

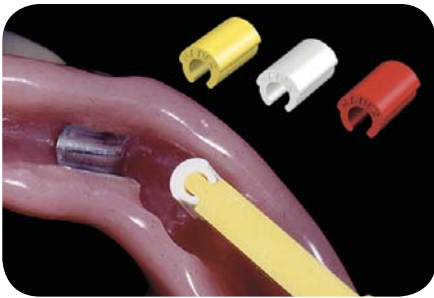
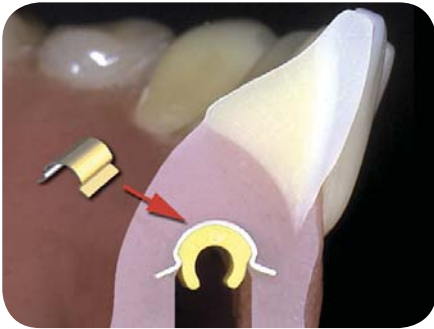

Recommended use is processing the metal housings into the denture simplifying clip placement and then using one of the three retention grips of plastic PRECI-HORIX clips in the metal housings.

White: reduced retention

Yellow: normal retention

Red: increased retention



The prevailing 1.8 mm bar pattern is also compatible with PRECI-CLIP riders.

EASY PROCESSING

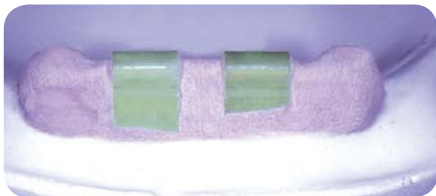
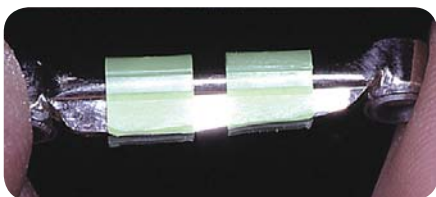
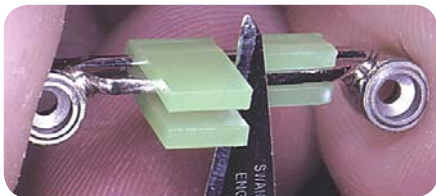

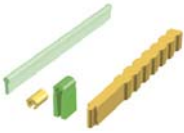

PRECI-HORIX STANDARD

1701

KIT

2 plastic bar patterns
6 yellow riders
6 processing riders
1 insertion tool

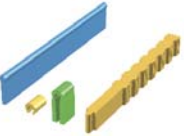

PRECI-HORIX PLASTICWAX

1731

KIT

2 PLASTICWAX bar patterns
6 yellow riders
6 processing riders
1 insertion tool



PRECI-HORIX COMBI

1741

KIT

1 plastic bar pattern
2 yellow riders
2 processing riders
2 stainless steel housings
1 insertion tool



PRECI-HORIX RIDER

Normal retention:

1802 **yellow** 6 pcs

1802B **yellow** 50 pcs

Reduced retention:

1805 **white** 6 pcs

1805B **white** 50 pcs

Increased retention:

1806 **red** 6 pcs

1806B **red** 50 pcs

Combination package:

1807 2 y + 2 r + 2 w

1807B 25 y + 15 r + 10 w



PRECI-HORIX METAL HOUSING

Ultrathin stainless steel housing with titanium/nitrate layer (gold-coloured) for a perfect fit of the riders in the prosthesis.

1706 6 pcs

1706B 50 pcs



PRECI-HORIX PLASTIC PATTERN

Burn-out plastic pattern.

Cast in any hard alloy.

Length: 50 mm - Height: 4 mm - ø 1.8 mm

1704 6 pcs

1704B 50 pcs

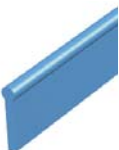

PRECI-HORIX PLASTICWAX PATTERN

Ideal for use with fast set investments.

Cast in any hard alloy.

Length: 50 mm - Height: 8.25 mm - ø 1.8 mm

1734 6 pcs

1734B 50 pcs

CEKA AXIAL
PRECI-CLIX AXIAL
PRECI-CLIX RADICULAR
PRECI-BALL

01.
**AXIAL
ATTACHMENTS**

CEKA EXTRACORONAL
CEKA ID
PRECI-VERTIX
PRECI-VERTIX AT
PRECI-CLIX EC
PRECI-SAGIX
PRECI-52
PRECI-TUBIX/MORTIX

02.
**EXTRACORONAL
ATTACHMENTS**

PRECI-BAR
PRECI-HORIX
PRECI-CLIP

03.
**PROFILE
ATTACHMENTS**

PRECI-PROFILE
PRECI-POST
CEKA SOL
CEKALLOY
CEKA SITE
CEKA BOND
3C-BOND
PERMA-RET
PRECI-SEP
PLASTICWAX
EXPANDO

SPECIALTIES

WWW.CKPL.EU

CEKA
ATTACHMENTS
PRECI-LINE



Prospectus n° **273.E-ed.B**

© Copyright ALPHADENT NV 10/2011 - BTW BE 0414.789.321 RPR Kortrijk

ALPHADENT NV • Textielstraat 24 8790 Waregem, Belgium

T+32 56 629 100 - **F**+32 56 629 101 - **E**info@ckpl.eu